

## Starck tubs & showers Whirltub # 760341000AS0000 / 760341000CE1000 / 760341000CP1000 / 760341000JS1000

| < 2000 mm > |

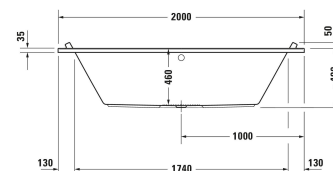
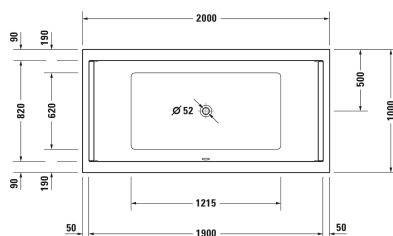
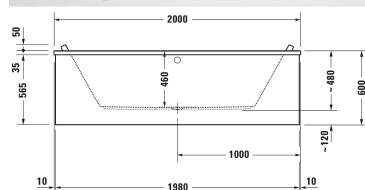

Whirltub	Dimension	Weight	Order number
Rectangular, 2000x1000 mm, Installation, White, Sanitary acrylic, Number of backrests: 2, Incl. support frame, Incl. waste and overflow, Waste outlet position: Middle, Overflow position: Middle, Capacity: 309 l, Internal depth: 460 mm			
<b>Colors</b>			
00 White Alpin			
<b>Variant</b>			
Air-System, 50 Hz, Protection type: IPX5		50.000 kg	760341000AS0000
Combi-System E, 50 Hz, Protection type: IPX5		70.000 kg	760341000CE1000
Combi-System P, 50 Hz, Protection type: IPX5		63.500 kg	760341000CP1000
Jet-System, 50 Hz, Protection type: IPX5		54.000 kg	760341000JS1000
<b>Suitable setting for Combi-System E, 50 Hz, Protection type: IPX5</b>			
Bathtub anchors	100 x 30 mm	0.63 kg	790103
Waste and overflow with inlet Base inlet, Quadroval, Bowden cable length: 940 mm, Diameter waste plug: 52 mm	400 x 80 mm	1.7 kg	791227
Tub heating	0 x 0 mm	1.5 kg	791882
Waste and overflow with inlet Tub filler, Quadroval, Bowden cable length: 750 mm, Diameter waste plug: 52 mm	400 x 80 mm	0 kg	791206
<b>Suitable products</b>			
Panel for corner right Scope of application: Inside, Incl. support frame: No, 1990 x 990 mm	1990 x 990 mm		ST8905
Back-to-wall panel Scope of application: Inside, Incl. support frame: No, 1980 x 990 mm	1980 x 990 mm		ST8903
Panel for corner left Scope of application: Inside, Incl. support frame: No, 1990 x 990 mm	1990 x 990 mm		ST8907

**Starck tubs & showers Whirltub # 760341000AS0000 /  
760341000CE1000 / 760341000CP1000 / 760341000JS1000**

|< 2000 mm >|

Panel for niche Scope of application: Inside, Incl. support frame: No, 1990 x 990 mm	1990 x 990 mm	ST8942
Tile flange , 3300 x 4 mm	3300 x 4 mm	790126
Tub handle Chrome, 311 x 56 mm	311 x 56 mm	792804
Front panel Scope of application: Inside, Incl. support frame: No, White, Sanitary acrylic, 2000 x 35 mm	2000 x 35 mm	701070
Side panel Scope of application: Inside, Incl. support frame: No, White, Sanitary acrylic, 1000 x 35 mm	1000 x 35 mm	701075
Headrest White, 250 x 250 mm	250 x 250 mm	790010

*All drawings contain the necessary measurements which are subject to standard tolerances. They are stated in mm and are non-binding. Exact measurements, in particular for customised installation scenarios, can only be taken from the finished piece.*