

Bento Starck Box Wall-mounted bidet # 227615..00 / 227615..00

| < 370 mm > |

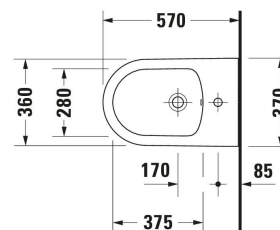
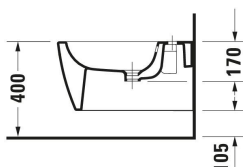
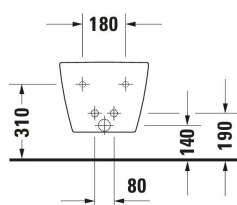

Wall-mounted bidet	Dimension	Weight	Order number
Tap hole platform: Yes, Number of faucet holes per wash area: 1, Incl. mounting material			
Colors			
20 HygieneGlaze (an antibacterial ceramic glaze that provides almost indefinite effectiveness) 30 White Satin Matt			
Variant			
White High Gloss, HygieneGlaze, Overflow: Yes, Incl. invisible fixation		21.000 kg	227615..00
White Satin Matt, HygieneGlaze, Overflow: Yes, Incl. invisible fixation		21.000 kg	227615..00
Accessory			
Installation element	530 x 55 mm	2.7 kg	695200
Siphon Chrome, Connection dimensions: 1 1/4", Floorstanding bidet, Wall-mounted bidet	210 x 110 mm	0.33 kg	005027
Mounting Suitable for Wall-mounted bidet, Wall-mounted toilet	Ø 12 mm	0.28 kg	006500
Suitable products			
Single lever bidet mixer Height: 155 mm, Spout reach: 121 mm, Ceramic cartridge, Connection type for water supply connection: Flexible connecting hoses, Dimension of connection hose: 3/8", Spray mode: Normal spray, Aerator with ball joint, recommended operating pressure: 1 - 5 bar, with pop-up waste set, 141 x 40 mm	141 x 40 mm		C12400001

All drawings contain the necessary measurements which are subject to standard tolerances. They are stated in mm and are non-binding. Exact measurements, in particular for customised installation scenarios, can only be taken from the finished piece.