

## Architec Corner Basin # 0448450000

| < 635 mm > |

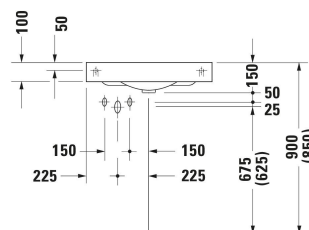
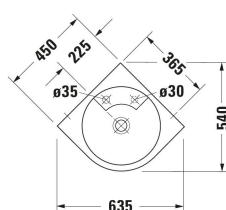

Corner Basin	Dimension	Weight	Order number
Quarter circle, Tap hole platform: Yes, Number of faucet holes per wash area: 1, Overflow: No, Underside glazed, Back side glazed: No, 635 mm			
<b>Colors</b>			
00 White Alpin			
<b>Variant</b>			
● ● White High Gloss, Semi-circular, Number of washing areas: 1 Middle, Number of faucet holes per wash area: 1 Middle, Soap dispenser position: Right		12.000 kg	0448450000
<b>Infobox</b>			
Pop-up waste cannot be used			
<b>Accessory</b>			
Slotted waste washbasin without overflow, Diameter: 72 mm	Ø 72 mm	0.45 kg	005024
<b>Recommended faucets</b>			
single lever basin mixer S Chrome, Ceramic cartridge, Height: 155,5 mm, Spout reach: 101 mm, Connection type for water supply connection: Flexible connecting hoses, Dimension of connection hose: 3/8", Spray mode: Normal spray, Aerator adjustable, Temperature limit adjustable, recommended operating pressure: 1 - 5 bar, Noise class: I, 137 x 42 mm	137 x 42 mm		B11010002
single lever basin mixer S Ceramic cartridge, Height: 155 mm, Spout reach: 91 mm, Connection type for water supply connection: Flexible connecting hoses, Dimension of connection hose: 3/8", Spray mode: Normal spray, Aerator adjustable, recommended operating pressure: 1 - 5 bar, Noise class: I, 121 x 40 mm	121 x 40 mm		C11010002
single lever basin mixer S Chrome, Ceramic cartridge, Height: 152 mm, Spout reach: 100,5 mm, Connection type for water supply connection: Flexible connecting hoses, Dimension of connection hose: 3/8", Spray mode: Normal spray, Aerator adjustable, Temperature limit adjustable, recommended operating pressure: 1 - 5 bar, Noise class: I, 137 x 42 mm	137 x 42 mm		B21010002

**Architec Corner Basin # 0448450000**

**|< 635 mm >|**

*All drawings contain the necessary measurements which are subject to standard tolerances. They are stated in mm and are non-binding. Exact measurements, in particular for customised installation scenarios, can only be taken from the finished piece.*